

C-TEK 3.96MM PITCH WIRE TO BOARD

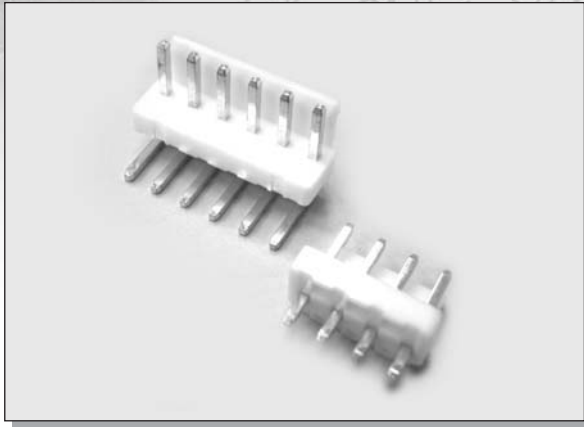

MATERIAL:

INSULATOR : NYLON 66.

UL 94V-0.

CONTACT : PHOSPHOR BRONZE.

ELECTRICAL CHARACTERISTICS:

CURRENT RATING : 5 AMPS.

WITHSTANDING VOLTAGE : 750V AC MIN.

CONTACT RESISTANCE : 30 MILLIOHMS MAX.

INSULATION RESISTANCE : 1000 MEGOHMS MIN.

OPERATING TEMPERATURE : -25°C ~ +85°C

DIMENSIONS

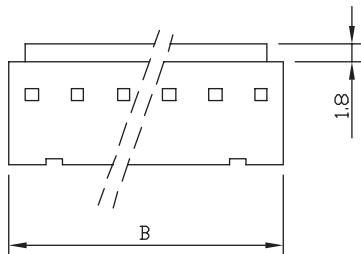

STRAIGHT

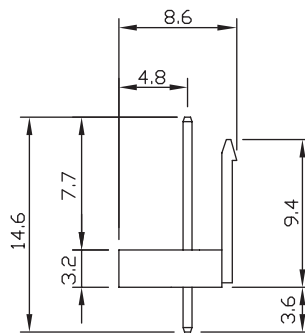
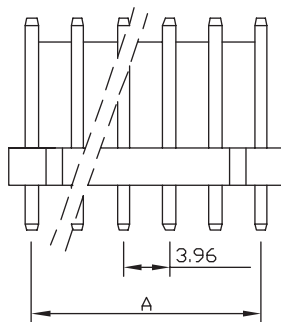

STRAIGHT

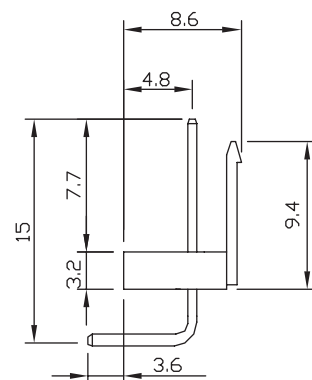

R/A

HOW TO ORDER

HOUSING

TERMINAL

SERIES NO.	CONTACT NO.	CONTACT TYPE	PLATING	SERIES NO.	CONTACT NO.	SERIES NO.	PLATING
3004	12 2 - 20	R R: R/A S: STRAIGHT	T T: TIN PLATED	3004A	12 2 - 20	3004A	T T: TIN PLATED